

WOOD DESTROYING PESTS AND ORGANISMS INSPECTION REPORT

BUILDING NO. 1926	STREET, CITY, STATE, ZIP HUXLEY COURT , SAN JOSE CA 95129	Date of Inspection 9/21/2009	No. of Pages 4
-----------------------------	---	--	--------------------------

ANTIQUE TERMITE, INC.

1913 Stone Avenue, San Jose, CA 95125
Ph: (408) 995-6300 (408) 995-0517 Fax

Firm Registration No. PR 1187	Report No. 42296	Escrow No.
Ordered By: ZIP REALTY 2041 MISSION COLLEGE BLVD #175 SANTA CLARA, CA 95054 Attn: DAVID HUNT 736-7693	Property Owner/Party of Interest ZIP REALTY 2041 MISSION COLLEGE BLVD #175 SANTA CLARA, CA 95054	Report Sent To:

COMPLETE REPORT <input checked="" type="checkbox"/>	LIMITED REPORT <input checked="" type="checkbox"/>	SUPPLEMENTAL REPORT <input type="checkbox"/>	REINSPECTION REPORT <input type="checkbox"/>
General Description: TWO STORY SINGLE FAMILY CONDOMINIUM WITH WOOD FRAME. LIMITED TO THE INTERIOR OF UNIT #1926 ONLY		Inspection Tag Posted:	
		Other Inspection Tags:	
An inspection has been made to the structure(s) shown on the diagram in accordance with the Structural Pest Control Act. Detached porches, detached steps, detached decks and any other structures not on the diagram were not inspected.			
Subterranean Termites <input type="checkbox"/> Drywood Termites <input type="checkbox"/> Fungus/Dryrot <input type="checkbox"/> Other Findings <input checked="" type="checkbox"/> Further Inspection <input checked="" type="checkbox"/>			
If any of above boxes are checked, it indicates that there were visible problems in accessible areas. Read the report for details on checked items.			

DIAGRAM NOT TO SCALE

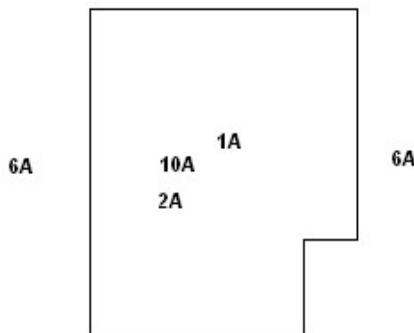

Inspected by LUIS E. RODRIGUEZ License No. FR38503 Signature 

You are entitled to obtain copies of all reports and completion notices on this property reported to the Structural Pest Control Board during the preceding two years. To obtain copies contact: Structural Pest Control Board, 2005 Evergreen Street, Suite 1500, Sacramento, California 95815-3831.

NOTE: Questions or problems concerning the above report should be directed to the manager of the company. Unresolved questions or problems with services performed may be directed to the Structural Pest Control board at (916) 561-8708, or (800) 737-8188 or www.pestboard.ca.gov. 43M-41 (Rev. 10/01)

1926

HUXLEY COURT, SAN JOSE CA 95129

9/21/2009

42296

BUILDING NO.

STREET, CITY, STATE, ZIP

INSPECTION DATE

REPORT NO.

AREAS NOT INSPECTED: The interior of hollow walls, areas beneath and behind built in cabinets were not inspected since inspection of these areas are considered impractical. We did not water test and do not certify against leakage of any appliances, plumbing over finished ceilings, roof coverings or decks. Such actions, were not performed, they are considered impractical without specific written authorization. Floors which are carpeted makes inspection of the flooring in these areas impractical. Soffitted (enclosed framing) areas of the structure, makes inspection of interior framing inaccessible for inspection. We make no guarantee against infestations, leaks or adverse conditions which may exist in such areas not inspected. Attached and/or detached fences were not inspected unless otherwise stated in the body of this report. Further inspection is recommended. Further inspection of any inaccessible area and/or area not inspected would be performed upon request at an additional charge (with written authorization). This property was not inspected for the presence or absence of health related molds or fungi. By California Law we are neither qualified, authorized, nor licensed to inspect for health related molds or fungi. If you desire information about the presence or absence of health related molds, you should contact an industrial hygienist.

No furniture or appliances were moved or removed, limiting this inspection to the visible and accessible areas of the above structure shown on the diagram. No statements can be made regarding conditions in closed walls, floors beneath coverings, areas below or behind appliances and built-in cabinet work, stall showers over finished ceilings, such structural segments as porte cocheres, enclosed bay windows, buttresses and similar areas to which there is no access without defacing or tearing out lumber, masonry or finished work. Antique Termite Inc. does not inspect roofs. Should interested parties desire further representation regarding roof, interested parties should contact a licensed roof contractor. Antique Termite assumes no responsibility for leaks not evident during the time of this inspections. Our inspectors are not equipped with extension ladders, therefore all buildings will be inspected from the ground level only. All wood members above 10 from the ground level would be visually inspected only (no probing, etc). Further inspection of these inaccessible area(s) or area(s) not inspected is recommended and will be performed upon request and at an additional fee.

REINSPECTIONS: If requested by the person ordering this report, a reinspection of the structure will be performed. This company will reinspect repairs done by others within four (4) months of the date of the original inspection. A charge, if any, can be no greater that the original inspection fee for each reinspection. The reinspection must be done within ten (10) working days of request. The reinspection is a visual inspection and if inspection of concealed areas is desired, inspection of work in progress will be necessary. Any guarantees must be received from parties performing repairs. Antique Termite & Pest Inc. does not guarantee work performed by others. Reinspection fee is payable at the time of inspection.

GUARANTEES: On work (labor) performed by Antique Termite Inc. are for one (1) year from the date of completion. Guarantees for local chemical treatments are limited to wood members treated only. Fumigations are guaranteed for one year from the date of completion. Plumbing repairs (parts provided by this firm), linoleum (vinyl materials), toilet resets or any other measures for the control of moisture (caulkings and grouts etc.) are guaranteed for thirty (30) days. Antique Termite, Inc. assumes no responsibility for water damage if the shower enclosure is not installed immediately. The guarantee on showers and tub units is void if the area is used before 24 hours. If the shower fixtures do not fit the owner must contact other tradesman to have new fixtures installed. If necessary for floor installation, vanities are to be removed and replaced by others. Kitchens and laundry areas also must have appliances removed before installation. An additional fee of \$ 75.00 per appliance and or furniture will be charged for Antique Termite to remove and/or reinstall. We do not do painting, texturing, staining or wallpapering.

Notice: Reports on this structure prepared by various registered companies should list the same findings (i.e. termite infestations, termite damage, fungus damage, etc.) However, recommendation to correct these findings may vary from company to company. You have a right to seek a second opinion from another company.

1926	HUXLEY COURT, SAN JOSE CA 95129	9/21/2009	42296
BUILDING NO.	STREET, CITY, STATE, ZIP	INSPECTION DATE	REPORT NO.

WHILE PERFORMING TREATMENTS OR ANY CONSTRUCTION REPAIRS, ANTIQUE TERMITE INC. WILL NOT BE RESPONSIBLE OR LIABLE FOR ANY DAMAGE TO ELECTRICAL OR PLUMBING WHICH MAY BE CONCEALED IN WALLS OR BELOW SLABS. BUILDING PERMITS REGARDING REPAIRS WHICH A BUILDING PERMIT IS REQUIRED, IF IT IS FOUND THAT LOCAL BUILDING CODES REQUIRE ADDITIONAL REPAIRS TO BE PERFORMED, THESE ADDITIONAL REPAIRS WOULD BE AT THE OWNERS EXPENSE AND SAME WOULD BE OUTLINED A SUPPLEMENTAL REPORT.

TILE OR LINOLEUM SELECTIONS: Bids which are given in report for replacement of ceramic tile or linoleum are based on using standard grade material. Ceramic tile bids are based on standard-square 4 tiles at a cost of \$2.78 per square foot for shower walls or tub shower walls. Ceramic floor tile bids are based on 8x8 tiles at \$2.75 per square foot. Tile selections can be made at Dal Tile 2549 Zanker Road San Jose CA 95131 408-435-1566. Linoleum bids are based on using standard grade linoleum at \$.99 per square foot. Linoleum selections can be made at Conklin Bros. 2250 Almaden Expressway San Jose CA 95125 (408) 266-2250. Tile and/or linoleum selections must be made at least 5 days prior to scheduled repairs. Any upgrades, must be paid by client at the time of selection. If NO selection is made prior to repairs, standard/neutral color tile or sheet vinyl will be installed.

MOLD POLICY STATEMENT: Molds, sometimes called mildew, are not wood destroying organisms. Branch 3 licensees do not have a duty under the Structural Pest Control Act and related regulations to classify molds as harmful to human health or not harmful to human health. This does not modify the Structural Pest Control Act or related regulations.

SECONDARY RECOMMENDATION (SUB STANDARD): Anytime a secondary recommendation (local treatment) is recommended, we must state who requested this secondary recommendation. Secondary recommendations are considered sub standard recommendations and guarantees are limited to treated areas only as stated in report.

THIS IS A SEPARATED REPORT WHICH IS DEFINED AS SECTION I, SECTION II AND UNKNOWN FURTHER INSPECTIONS CONDITIONS EVIDENT ON THE DATE OF INSPECTION.

SECTION I: Contains items where there is evidence of active infestations, infections, or conditions which have resulted in or from infestation or infection.

SECTION II: Are conditions deemed likely to lead to infestation or infection, but where there is no visible evidence of such found.

UNKNOWN FURTHER INSPECTION: Recommendations to inspect areas which during the original inspection, did not allow the inspector access to complete the inspection and cannot be defined as Section 1 or Section 2.

NOTE: This is a limited inspection report at the request of David Hunt and it is limited to the interior of unit #1926 only and does not include any other areas of structure. A complete inspection of entire building is recommended, but was not requested at this time.

SUB STRUCTURE AREA:

ITEM 1A NOTE: The dwelling is constructed over a concrete slab with finished walls on the interior and exterior which limits our inspection to the accessible areas. No representation can be made in regards to the absence or presence of infestations or infections in these inaccessible areas.
***** Information Item *****

NOTE

1926

HUXLEY COURT, SAN JOSE CA 95129

9/21/2009

42296

BUILDING NO.

STREET, CITY, STATE, ZIP

INSPECTION DATE

REPORT NO.

STALL SHOWER:

ITEM 2A FINDING: The second story hall bathroom shower and/or tub shower was not water tested due to being located over a finished ceiling.

RECOMMENDATION: Further inspection recommended. If so desired, (with written permission from the owner) we would perform water testing and further inspection. Any additional findings would be issued on a supplemental report. Note By signing the authorization the owner releases Antique Termite, Inc. of any liability for damage to the ceilings or other areas which could be damaged by water.

***** Unknown Further Inspection Recommended *****

\$ 150.00

ABUTMENTS:

ITEM 6A NOTE: Common wall exists with this unit and other units. Antique Termite cannot assume any responsibility for conditions which may extend from these inaccessible areas after this inspection.

***** Information Item *****

NOTE

OTHER-INTERIORS:

ITEM 10A FINDING: The linoleum was noted to be lifting at the hall bathroom adjacent to the tub shower.

RECOMMENDATION: Other trades to re-glue as needed.

***** This is a Section 2 Item *****

OTHERS

If it is found that during the course of repairs, damage and/ or infestation is found to extend into previously inaccessible areas, a supplemental report will be issued outlining findings and costs for any additional repairs or treatments. Antique Termite Inc. does not do any texturing, painting or wall papering.

Antique Termite, Inc. does not guarantee work performed by others. Such guarantees should be obtained from those performing the repairs. Antique Termite, Inc. only certifies the absence of infestation or infection in the visible and accessible areas. If it is found that others have concealed or hidden infestations or infections during the course of their repairs, it will be the responsibility of interested parties to pursue the responsible party. Antique Termite, Inc. does not inspect for or comment on workman like manor on repairs done by others. Interested parties must satisfy themselves with the proper permits and licenses and to the quality or appearance of work which is not completed by our company.

All repairs completed by others must be reinspected by Antique Termite before certification will be issued. The reinspection will only CERTIFY the absence of infestation of infection in the visible and accessible areas. Antique Termite does not guarantee work completed by others, nor does this firm make any statements concerning workmanship of those repairs. Workmanship is only determinable by those paying for or receiving those services. A reinspection of specific items on the report or of any other condition pertaining to this structure can be done at an additional cost of \$150.00 per trip. This reinspection must be performed within four (4) months of the Original Inspection Report.

REINSPECTION FEE OF \$150.00 IS PAYABLE AT THE TIME OF INSPECTION.

THIS IS TO CERTIFY THAT THE (INTERIOR ONLY) AT THE ABOVE PROPERTY WAS INSPECTED ON THE DATE INDICATED, IN ACCORDANCE WITH THE STRUCTURAL PEST CONTROL ACT AND RULES AND REGULATIONS ADOPTED PURSUANT THERETO, AND THAT NO EVIDENCE OF ACTIVE INFESTATION OR INFECTION WAS FOUND IN THE VISIBLE AND ACCESSIBLE AREAS.